

TELE- SPEECH THERAPY: DYSPHAGIA ASSESSMENT & REHABILITATION

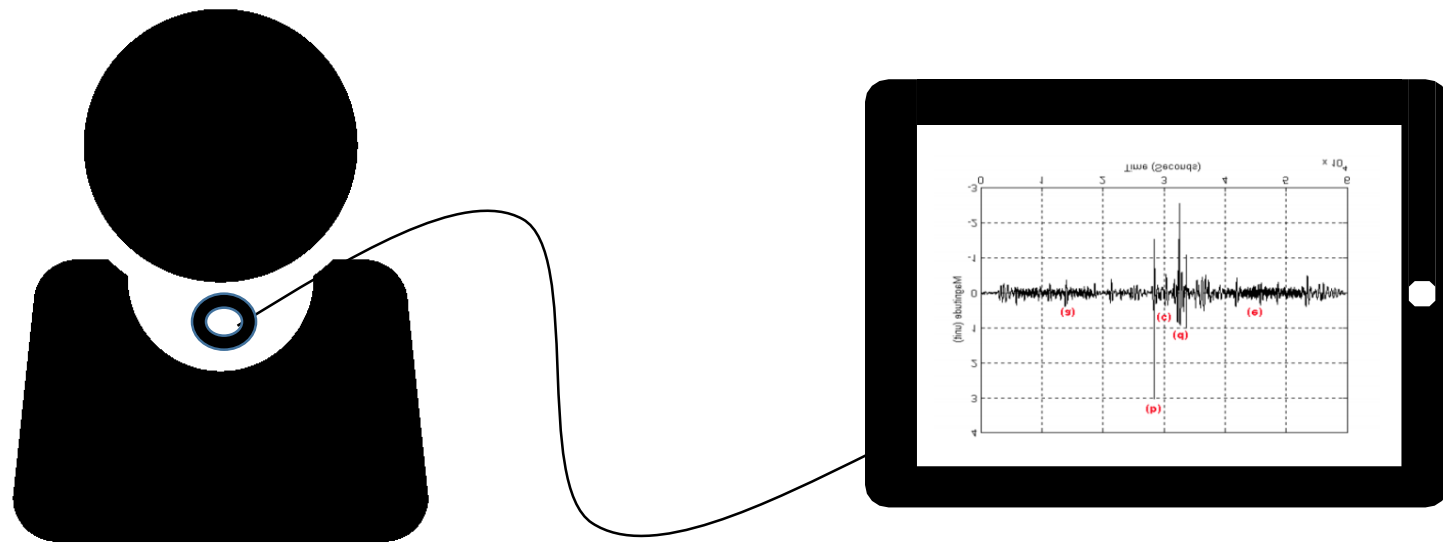

The tele- speech therapy app is designed to allow speech therapists remotely assess a patient's ability to swallow following the diagnosis of certain neurological disorders.



A non-invasive microphone is attached to the neck with adhesive dressing.

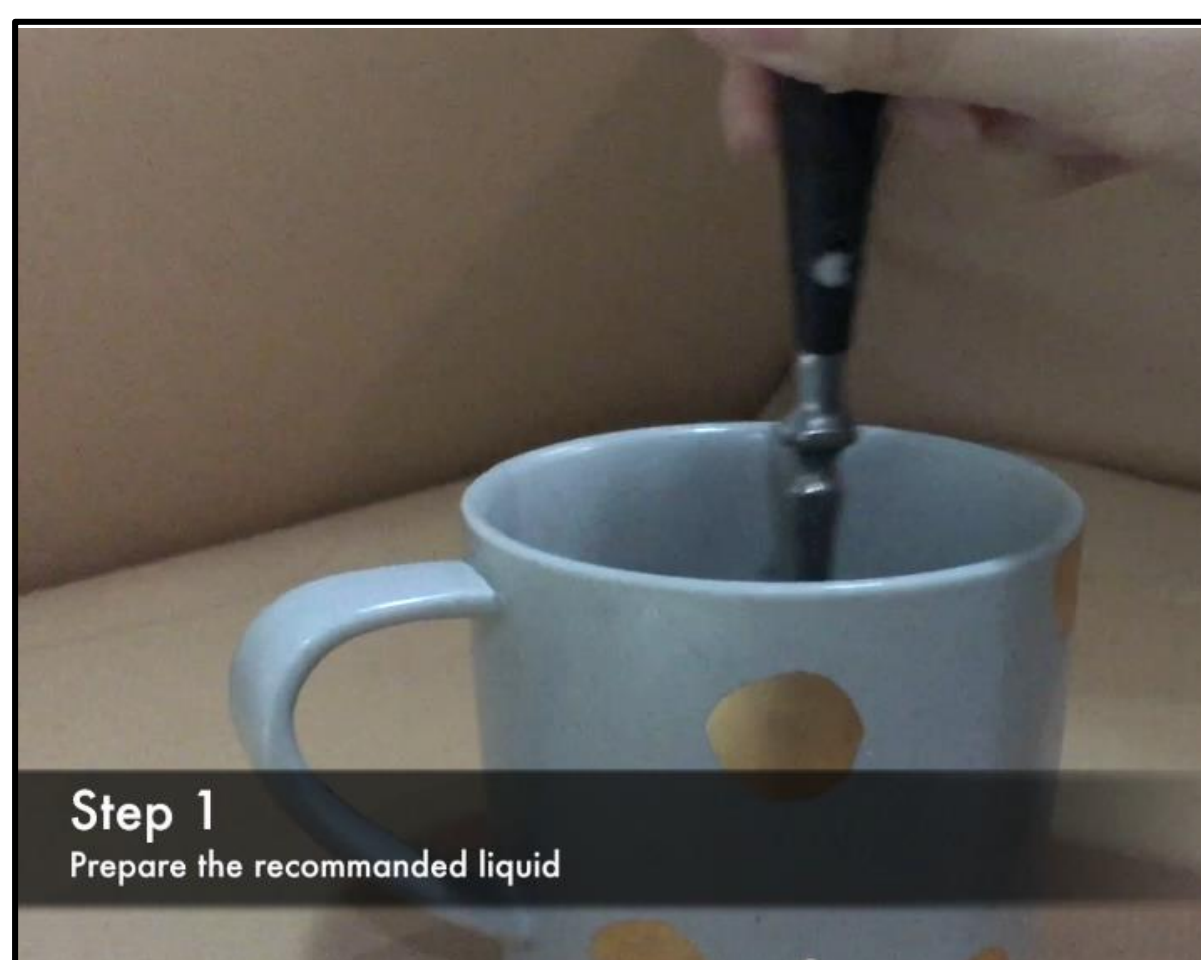

Instructional videos on liquid consistency preparation.

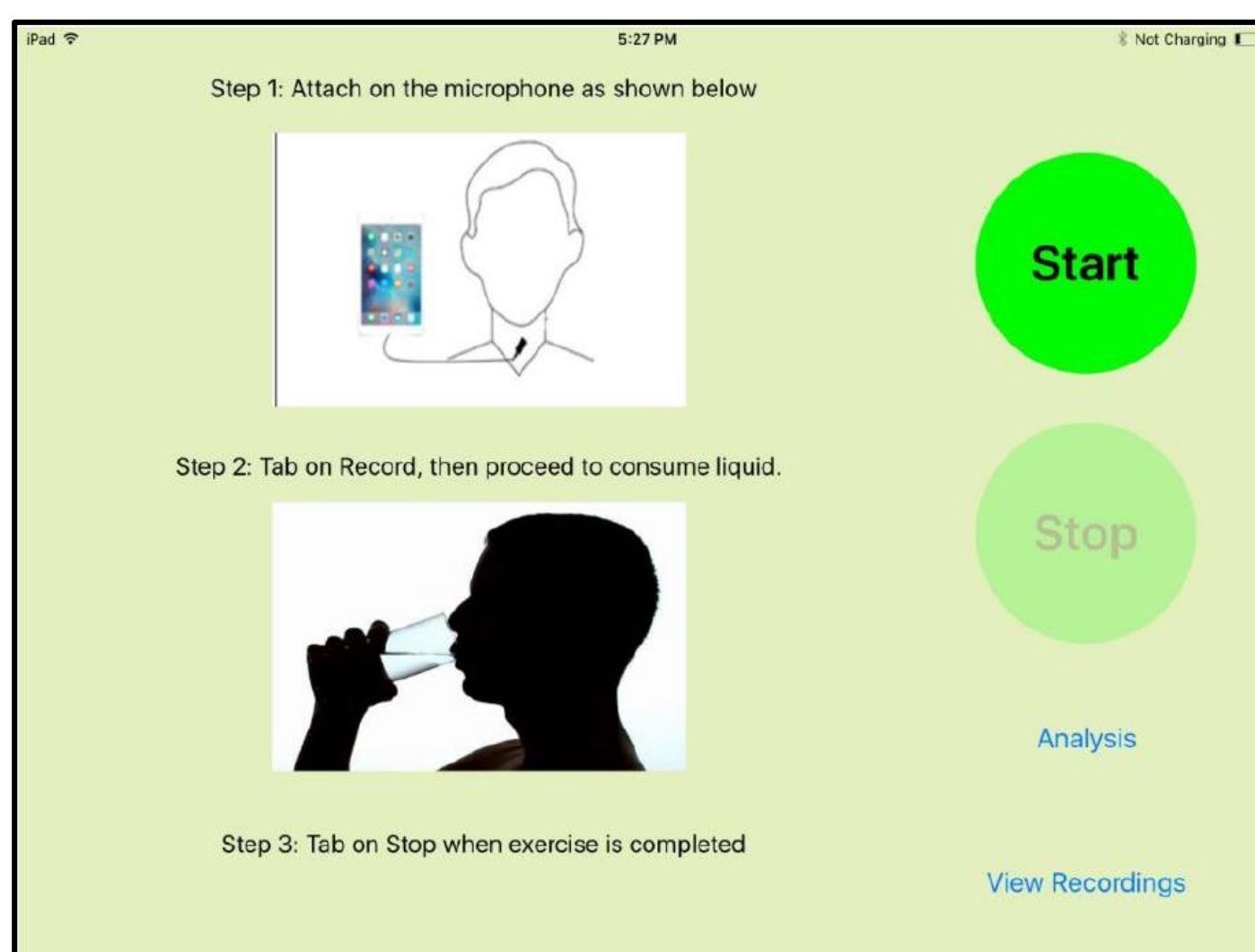

Simple user interface for patients to use independently.

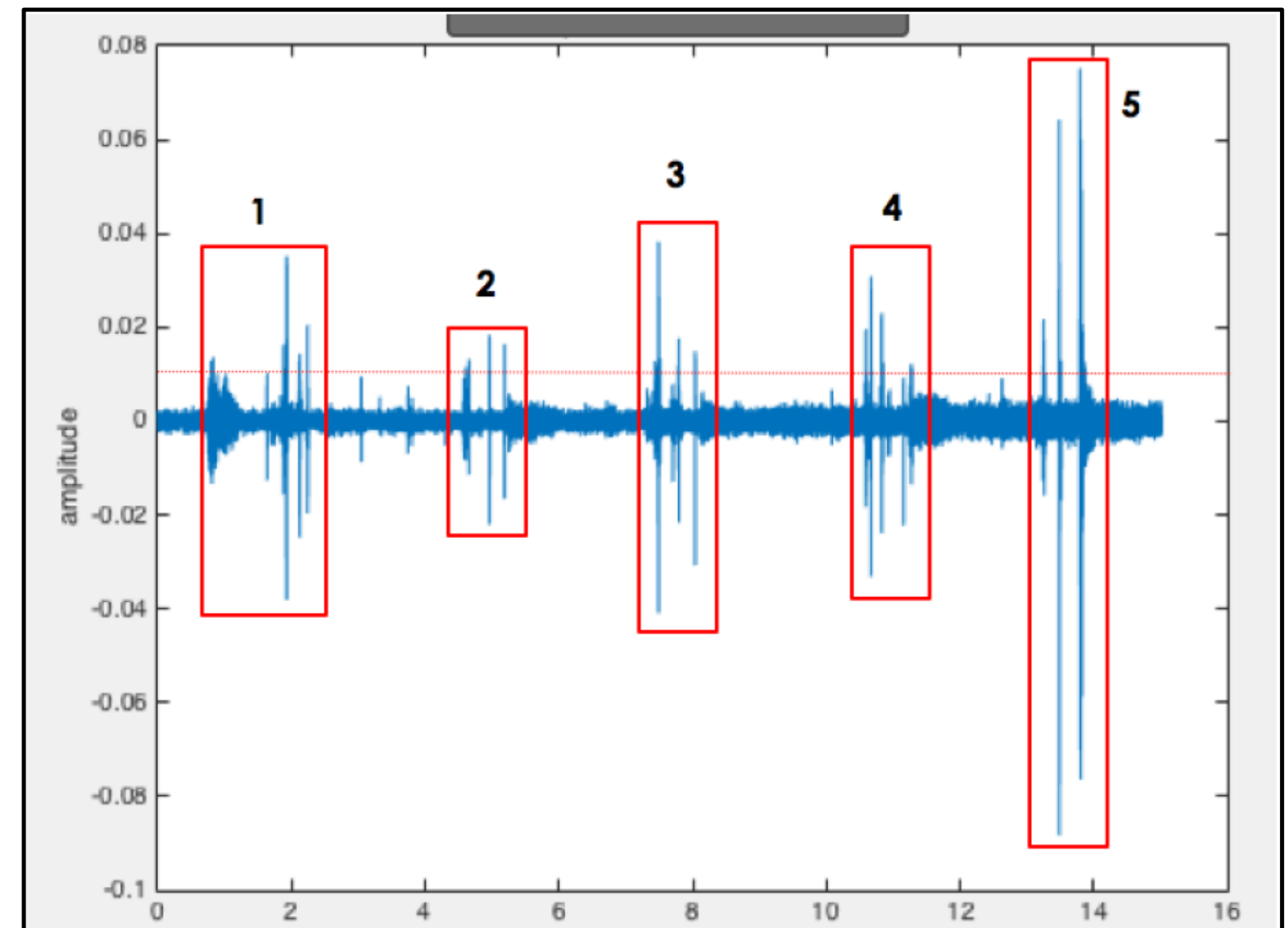

Algorithms to detect normal swallowing and coughing.

Text transcripts of patient's swallowing and coughing.

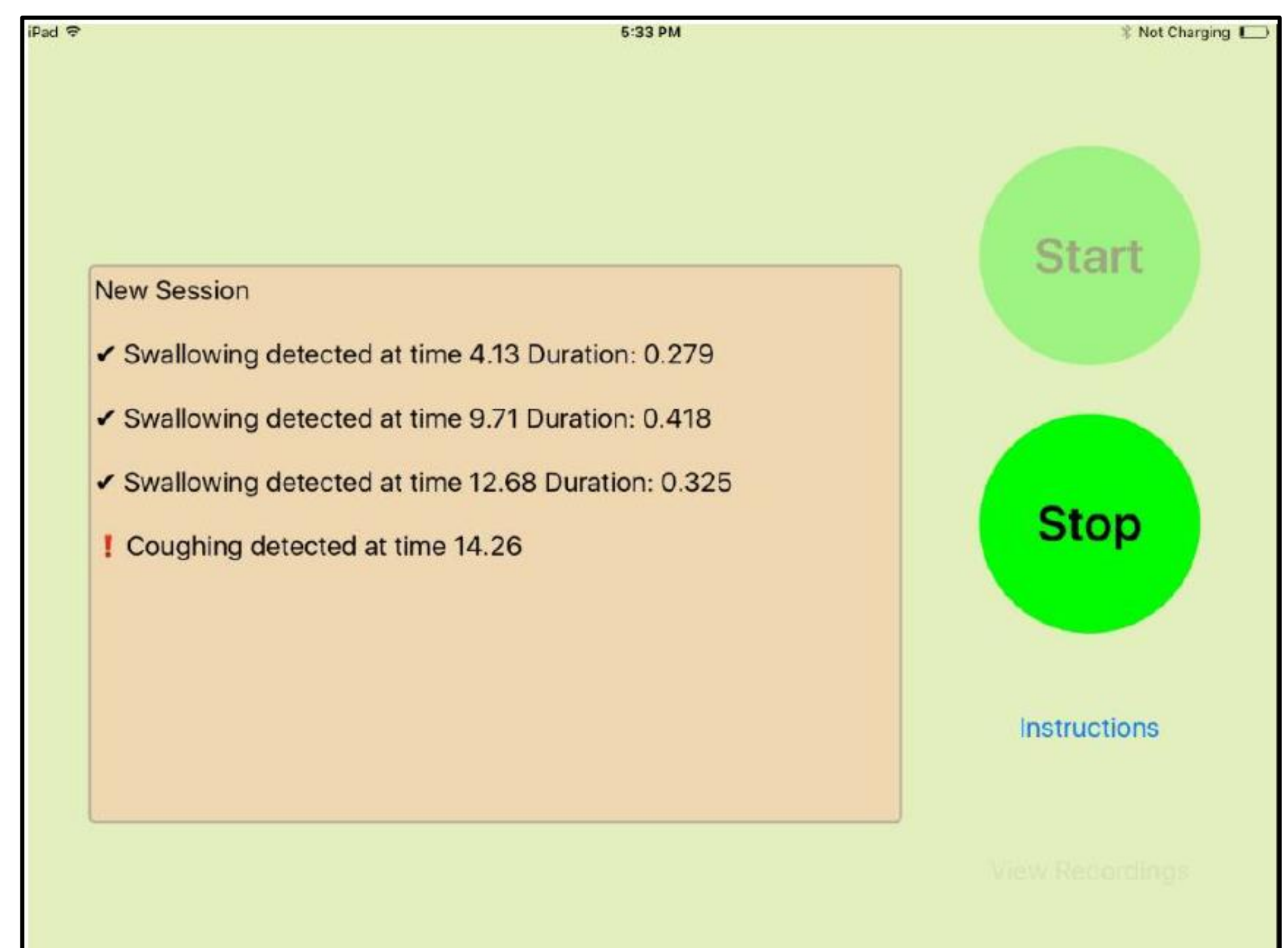

Transcripts can be easily reviewed by speech therapists anytime.



Saw Swee Hock
School of Public Health



Department of Electrical & Computer Engineering
Faculty of Engineering

For more information, email arthurtay@nus.edu.sg